



FITTING INSTRUCTIONS FOR TP0014 FOOTBOARD SLIDERS
HONDA INTEGRA 2012-



THIS KIT CONTAINS THE ITEMS PICTURED AND LABELLED BELOW.
DO NOT PROCEED UNTIL YOU ARE SURE ALL PARTS ARE PRESENT.

Please note that the way the kit is packed does not necessarily represent the way of mounting to the bike.

THE PARTS SHOWN MAY BE REPRESENTATIVE ONLY (FOR CLARITY OF INSTRUCTIONS ONLY)

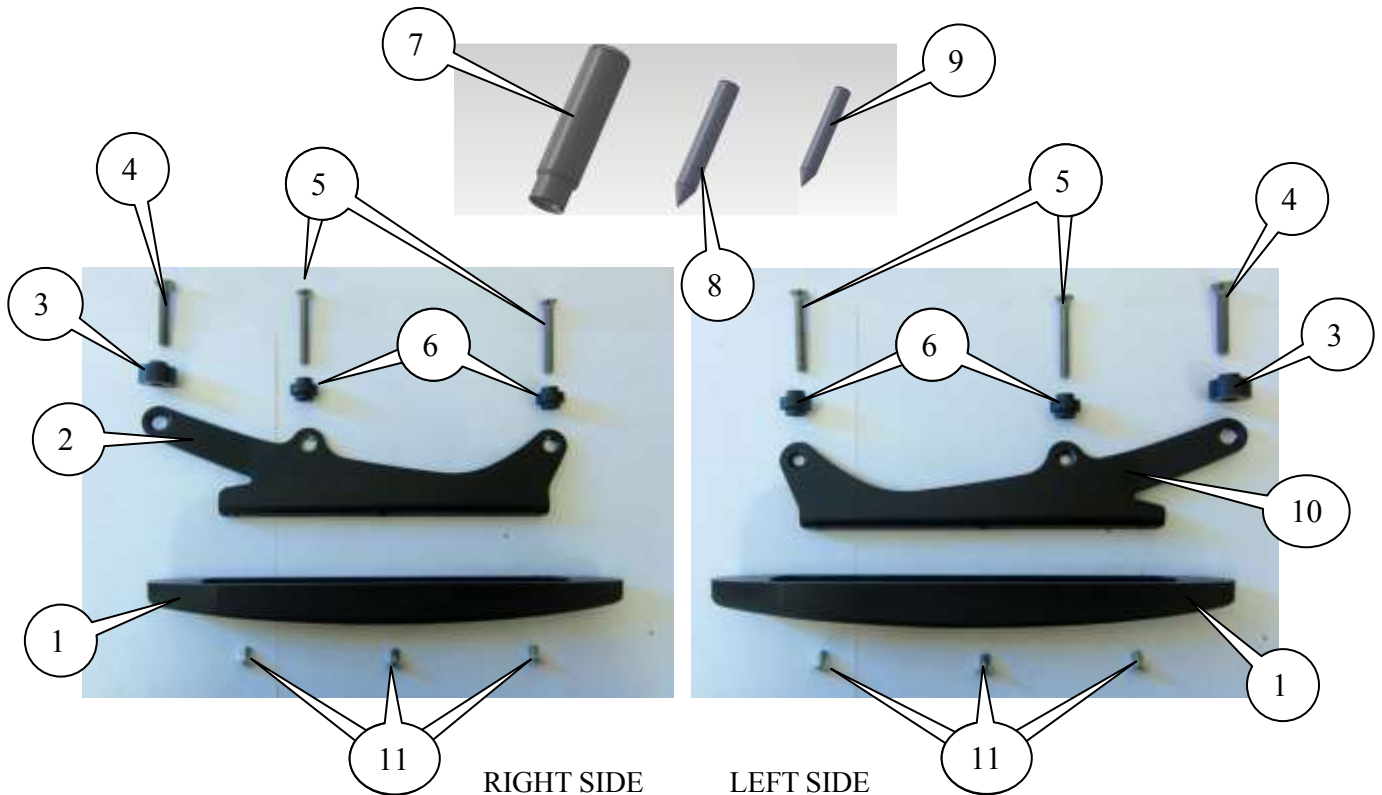



LEGEND

- ITEM 1 = SLIDER (SL0007) (x2).
- ITEM 2 = MOUNTING PLATE RIGHT SIDE (MP0037) (x1).
- ITEM 3 = SPACER (S0543) 12mm LONG (x2).
- ITEM 4 = M6 x 40mm LONG COUNTERSUNK BOLTS (x2).
- ITEM 5 = M5 x 30mm LONG COUNTERSUNK BOLTS (x4).
- ITEM 6 = SPACER (S0544) 11.5mm LONG (x4).
- ITEM 7 = 10.5mm PUNCH TOOL (x1).
- ITEM 8 = M6 MARKING TOOL (40mm long) (x1).
- ITEM 9 = M5 MARKING TOOL (25mm long) (x1).
- ITEM 10 = MOUNTING PLATE LEFT SIDE (MP0036) (x1).
- ITEM 11 = M5 x 12mm LONG COUNTERSUNK BOLTS (x6).

Please note that in cases where kits are packed with rubber washers holding the components onto the bolt – *the rubber washers should be thrown away!*

TOOLS REQUIRED

- Set of metric Allen keys to include 3 & 4mm A/F sizes.
 - 10mm Socket and wrench.
 - Hammer/mallet.

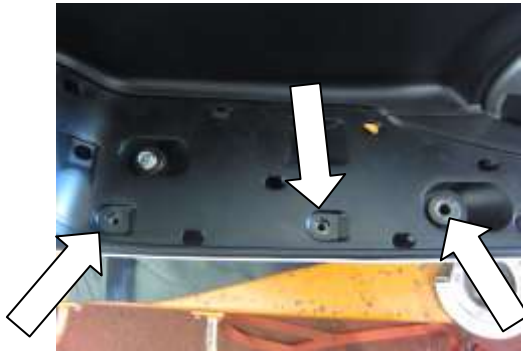

PICTURE 1



PICTURE 2



PICTURE 3



PICTURE 4



PICTURE 5

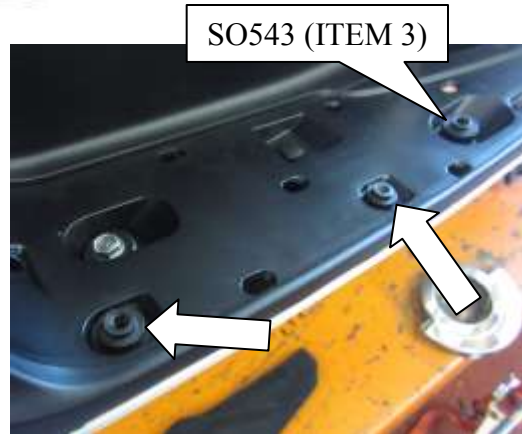

PICTURE 6

FITTING INSTRUCTIONS

- To fit the left side, remove the original rubber foot plate by lifting a corner and gently pulling.
- Remove the 10mm bolt towards the rear of the footboard mounting area and two of the button head bolts along the side, as arrowed in picture 1.
- Take the M6 marking tool (item 8) that is in the kit and screw into the hole where the 10mm bolt was removed, ensuring the point is at the top, as shown in picture 2. Re-fit the original rubber foot plate and gently apply some pressure to the area around the marking tool. *This should give a small indentation to locate where to punch a hole through the rubber in order to fit the bolt.* Use the same process to locate the other two holes, this time using the M5 marking tool (item 9).
- With the rubber removed from the scooter, use the 10.5mm Punch Tool (item 7) supplied with the kit along with a hammer/mallet to create three holes where there are now marks, as shown in picture 3. *This should be done with a scrap piece of wood underneath the rubber and on a hard surface.*
- These holes then allow the top of the spacers to fit through in order for the bolt to tighten against, as shown in picture 4.
- Take the left side mounting plate (item 10) and fit the slider (item 1) using three of the M5 countersunk bolts (item 11). Fit the bolts through the slider and screw into the mounting plate and tighten, as shown in picture 5.
- On the scooter, position the larger spacer (item 3) in the rear recess (with the stepped down smaller diameter facing upwards) and two of the smaller spacers (item 6) in the two side recesses (again, with the 10mm diameter boss facing upwards), as arrowed in picture 6.
- Re-fit the original foot plate rubber, ensuring that the tops of the three spacers fit through the holes that have just been punched in the rubber.
- Offer the R&G footboard slider assembly into position and insert two M5 x 30mm long countersunk bolts (item 5) into the two side spacers and the M6 x 40mm long countersunk bolt (item 4) into the rear spacer, sandwiching the rubber, before tightening evenly.
- To fit the right side, follow the same procedure as above.



CONSUMER NOTICE

The catalogue description and any exhibition of samples are only broad indications of the Products and R&G may make design changes which do not diminish their performance or visual appeal and supplying them in such state shall conform to the order. The Buyer acknowledges no representation or warranty (other than as to title) has been given or will apply to the Products other than those in R&G's order or confirmation and the Buyer confirms it has chosen the Products as being of merchantable quality and suitable for its particular purposes. Where R&G fits the Products or undertakes other services it shall exercise reasonable skill and care and rectify any fault free of charge unless the workmanship has been disturbed. The Buyer is responsible for ensuring that the warranty on the motorcycle is not affected by the fitting of the Products. On return of any defective Products R&G shall at its option either supply a replacement or refund the purchase money but shall not be liable if the Products have been modified or used or maintained otherwise than in accordance with R&G's or manufacturer's instructions and good engineering practice or if the defect arises from accident or neglect. Other than identified above and subject to R&G not limiting its liability for causing death and personal injury, it shall not be liable for indirect or consequential loss and otherwise its liability shall be limited to the amounts paid by the Buyer for the Products or the fitting or service concerned. These terms do not affect the Buyer's statutory rights.

R&G RACING RETURNS POLICY (NON-FAULTY GOODS)

Returns must be pre-authorized (if not pre-authorized the return will be rejected). Goods may only be returned direct to us if they were purchased direct from us (customer must prove if necessary). Otherwise to be returned to original vendor. Goods must be in re-sellable condition, in the opinion of R&G Racing. All returns are subject to a 25% restocking and handling fee (25% of the gross value exc. P&P – at the prevailing price at time of purchase). The customer must pay any and all carriage charges. No returns of discontinued products, unless within 14 days of purchase. This policy does not affect your statutory rights and does not refer to faulty goods.



Instructions de montage pour TP0014 Sliders repose pied
HONDA INTEGRA 2012-



Le kit contient les articles exposés ci-dessous, vérifier que toutes les pièces soient présentes avant de procéder au montage.

La façon dont le kit est emballé ne correspond pas forcément à la façon de monter les pièces sur la moto.

Les pièces présentées peuvent n'être que représentatives, afin de faciliter et clarifier les instructions de montage.

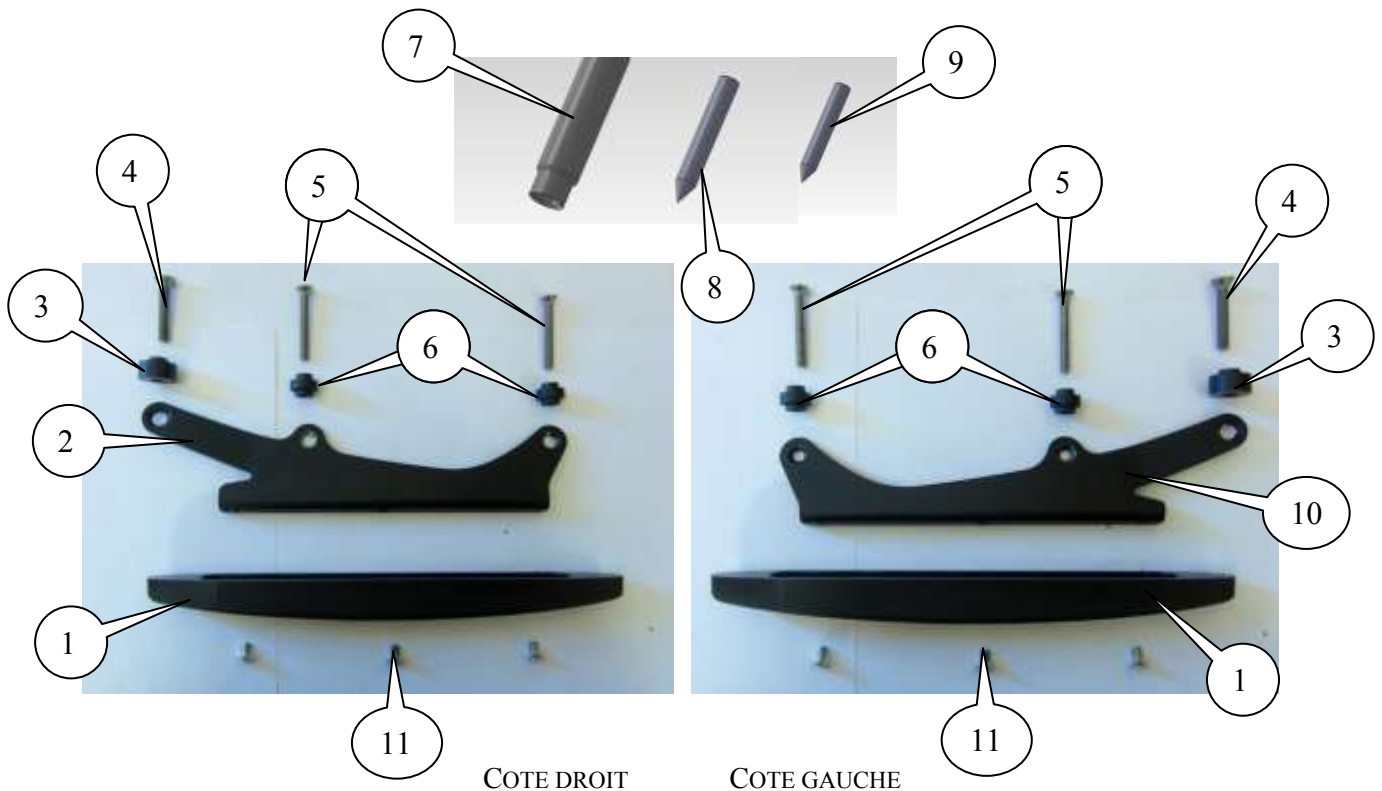



LEGENDE

- ARTICLE 1 = Slider (SL0007) (x2).
ARTICLE 2 = Plaque de montage coté droit (MP0037) (x1).
ARTICLE 3 = Entretoise (S0543) 12mm de long (x2).
ARTICLE 4 = M6 x 40mm Boulons à tête fraisée (x2).
ARTICLE 5 = M5 x 30mm Boulons à tête fraisée (x4).
ARTICLE 6 = Entretoise (S0544) 11.5mm de long (x4).
ARTICLE 7 = 10.5mm Outil de pousse (x1).
ARTICLE 8 = M6 Outil de marquage (40mm de long) (x1).
ARTICLE 9 = M5 Outil de marquage (25mm de long) (x1).
ARTICLE 10 = Plaque de montage coté gauche (MP0036) (x1).
ARTICLE 11 = M5 x 12mm Boulons à tête fraisée (x6).

Notez que si les kits sont emballés avec des rondelles en caoutchouc servant à tenir les composants, *ces rondelles doivent être jetées.*

Outils requis

- Clés Allen 3 et 4mm
- Clé 10mm
- Maillet

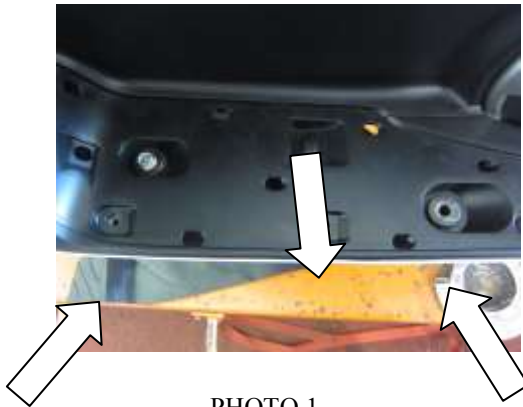

PHOTO 1



PHOTO 2



PHOTO 3



PHOTO 4



PHOTO 5



PHOTO 6

Instructions de montage

Coté gauche:

- Retirez le repose pied en caoutchouc d'origine en soulevant un coin et en tirant doucement.
- Enlever le boulon de 10mm contre l'arrière du support repose pied area et 2 des boulons sur le coté (photo 1).
- Prendre l'outil de marquage M6 (Article 8) présent dans le kit et visser dans le trou d'où le boulon de 10mm a été enlevé, en vous Assurant que la pointe soit vers le haut (photo 2).
- Remettre le repose pied d'origine en caoutchouc et effectuer une pression sur l'espace entourant l'outil de marquage. *Cela devrait aider à localiser l'espace où faire un trou à travers le caoutchouc afin de passer le boulon. Utiliser le même process pour localiser les 2 autres trous*, en utilisant l'outil de marquage M5 (Article 9).
- Avec le caoutchouc retiré du scooter, utiliser l'outil de pousse 10.5mm (Article 7) fourni avec le kit avec un maillet pour créer 3 trous où il y a des marques (photo 3). *Cela peut s'effectuer à l'aide d'un morceau de bois sous le caoutchouc et sur une surface dure.*
- Ces trous permettent au dessus des entretoises de passer à travers le repose pied en caoutchouc (Photo 4).
- Prenez la plaque de montage coté gauche (Article 10) et passer le slider (Article 1) en utilisant 3 des boulons M5 à tête fraisée (Article 11). Passer les boulons à travers le slider et vissez-le dans la plaque de montage (photo 5). Serrez.
- Sur le scooter, positionnez l'entretoise la plus large (Article 3) dans le creux arrière (Avec le plus petit diamètre vers le haut) et 2 des plus petites entretoises (Article 6) des 2 cotés (une nouvelle fois, avec le diamètre de 10mm vers le haut) (Photo 6).
- Remettre le repose pied d'origine en vous assurant que les dessus des 3 entretoises aillent à travers les trous qui viennent juste d'être poussé dans le caoutchouc.
- Montez le slider repose pied R&G sur la moto et insérer 2 boulons à tête fraisée M5 x 30mm (Article 5) dans les entretoises des 2 cotés et le boulon M6 x 40mm (Article 4) dans l'entretoise arrière, prenant en sandwich le caoutchouc, avant de serrer de façon égale.

R&G Racing

Unit 1, Shelley's Lane, East Worldham, Alton, Hampshire, GU34 3AQ

Tel: +44 (0)1420 89007 Fax: +44 (0)1420 87301 www.rg-racing.com Email: info@rg-racing.com



Répéter ces actions pour le coté droit

CONSUMER NOTICE

The catalogue description and any exhibition of samples are only broad indications of the Products and R&G may make design changes which do not diminish their performance or visual appeal and supplying them in such state shall conform to the order. The Buyer acknowledges no representation or warranty (other than as to title) has been given or will apply to the Products other than those in R&G's order or confirmation and the Buyer confirms it has chosen the Products as being of merchantable quality and suitable for its particular purposes. Where R&G fits the Products or undertakes other services it shall exercise reasonable skill and care and rectify any fault free of charge unless the workmanship has been disturbed. The Buyer is responsible for ensuring that the warranty on the motorcycle is not affected by the fitting of the Products. On return of any defective Products R&G shall at its option either supply a replacement or refund the purchase money but shall not be liable if the Products have been modified or used or maintained otherwise than in accordance with R&G's or manufacturer's instructions and good engineering practice or if the defect arises from accident or neglect. Other than identified above and subject to R&G not limiting its liability for causing death and personal injury, it shall not be liable for indirect or consequential loss and otherwise its liability shall be limited to the amounts paid by the Buyer for the Products or the fitting or service concerned. These terms do not affect the Buyer's statutory rights.

R&G RACING RETURNS POLICY (NON-FAULTY GOODS)

Returns must be pre-authorized (if not pre-authorized the return will be rejected). Goods may only be returned direct to us if they were purchased direct from us (customer must prove if necessary). Otherwise to be returned to original vendor. Goods must be in re-sellable condition, in the opinion of R&G Racing. All returns are subject to a 25% restocking and handling fee (25% of the gross value exc. P&P – at the prevailing price at time of purchase). The customer must pay any and all carriage charges. No returns of discontinued products, unless within 14 days of purchase. This policy does not affect your statutory rights and does not refer to faulty goods.